

# YOUR SAFETY IS OUR FIRST PRIORITY

e-NRG is only suitable for use in liquid bioethanol fires. Do not use in anything with a wick. Always follow recommended procedures provided by the fireplace manufacturer.

Refer to the Safety Data Sheet (SDS) for important Health and Safety information.

**WARNING:** Fuel containers without flame arresters, if used improperly, can result in the inflammation of the fuel within the container, which may cause property damage, personal injury, or even death.

**NEVER pour e-NRG over an open flame.**  
**NEVER fill an appliance/burner directly from the e-NRG bottle, risk of explosion.**



Do not fill while hot



Do not fill while operating



Do not overfill



Flammable

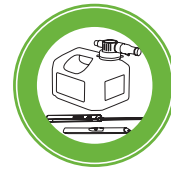

Use with supplied accessories



Keep away from children

## INSTRUCTIONS FOR SAFE USE

This decanting procedure must be performed in a well ventilated space away from any sources of ignition.

### If you are using an Approved Adapter:

An Adapter is available to connect the Safety Spout to the e-NRG bottle which eliminates the need to decant the fuel from the bottle into the Jerry Can. If you are an owner of an authentic EcoSmart Fire you would have received a Jerry Can with an attached Safety Spout as part of their standard operating accessories.

1. Attach the Adapter to the Safety Spout. Do not over tighten.
2. Attach the Safety Spout with Adapter to the e-NRG bottle and ensure it is securely fastened. You are ready to approach the Burner (the burner must be in an off/cold state).

Without the e-NRG Adapter the procedure below must be followed. Manuals and videos are available on [ecosmartfire.com/learn/safety/](http://ecosmartfire.com/learn/safety/)



### If you are using an Approved Jerry Can:

e-NRG must be decanted into an approved Jerry Can following the instructions outlined below.

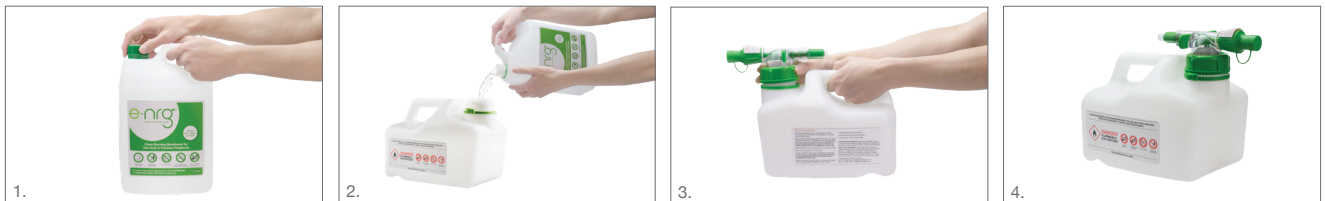

1. Remove the cap from your e-NRG bottle.
2. Carefully decant the fuel from the bottle into the Jerry Can through its opening, avoiding spillage (you may need to decant multiple bottles depending on the packaging volume purchased).  
If spillage occurs, clean thoroughly before proceeding.
3. Re-screw the spout back onto the Jerry Can to contain fuel and avoid accidental spillage. Do not over tighten.  
Test that it is closed securely before moving away from your decanting area.
4. You are ready to approach the Burner (the burner must be in an off/cold state).  
Once the e-NRG bottle is empty, put the original lid securely back onto the bottle and recycle appropriately.